



YUM YUM TREE PLAZA

815 South U.S. Highway 1, Jupiter, Florida 33477



Property for Lease

- New retail redevelopment in Jupiter!
- Conveniently located on one of Jupiter's main thoroughfares
- Aggressive lease rates
- Brand new, first generation retail space

DEMOGRAPHIC SUMMARY

	3-MILE RADIUS	5-MILE RADIUS
Postal count population	46,695	102,475
Median age	52.1	49.7
Estimated Average Household Income	\$111,983	\$116,958
Estimated Median Household Income	\$74,734	\$79,473

Cohen Commercial Realty, Inc.

Bryan S. Cohen | info@cohencommercial.com

Office: 561.471.0212 • Leasing: 561.471.1299 • Fax: 561.471.5905

533 NORTHLAKE BOULEVARD • NORTH PALM BEACH, FL 33408 • POST OFFICE BOX 14127 • NORTH PALM BEACH, FL 33408

LICENSED REAL ESTATE BROKER

All information regarding this property has been obtained from sources believed to be reliable. We make no guarantee, warranty, or representation about it. It independently confirm its accuracy and completeness. Any projections, assumptions, opinions or estimates used are for example only and do not represent current or future performance. You and your advisors should conduct a careful, independent investigation of the property to determine to your satisfaction the suitability of the property for your needs.

SITE PLAN

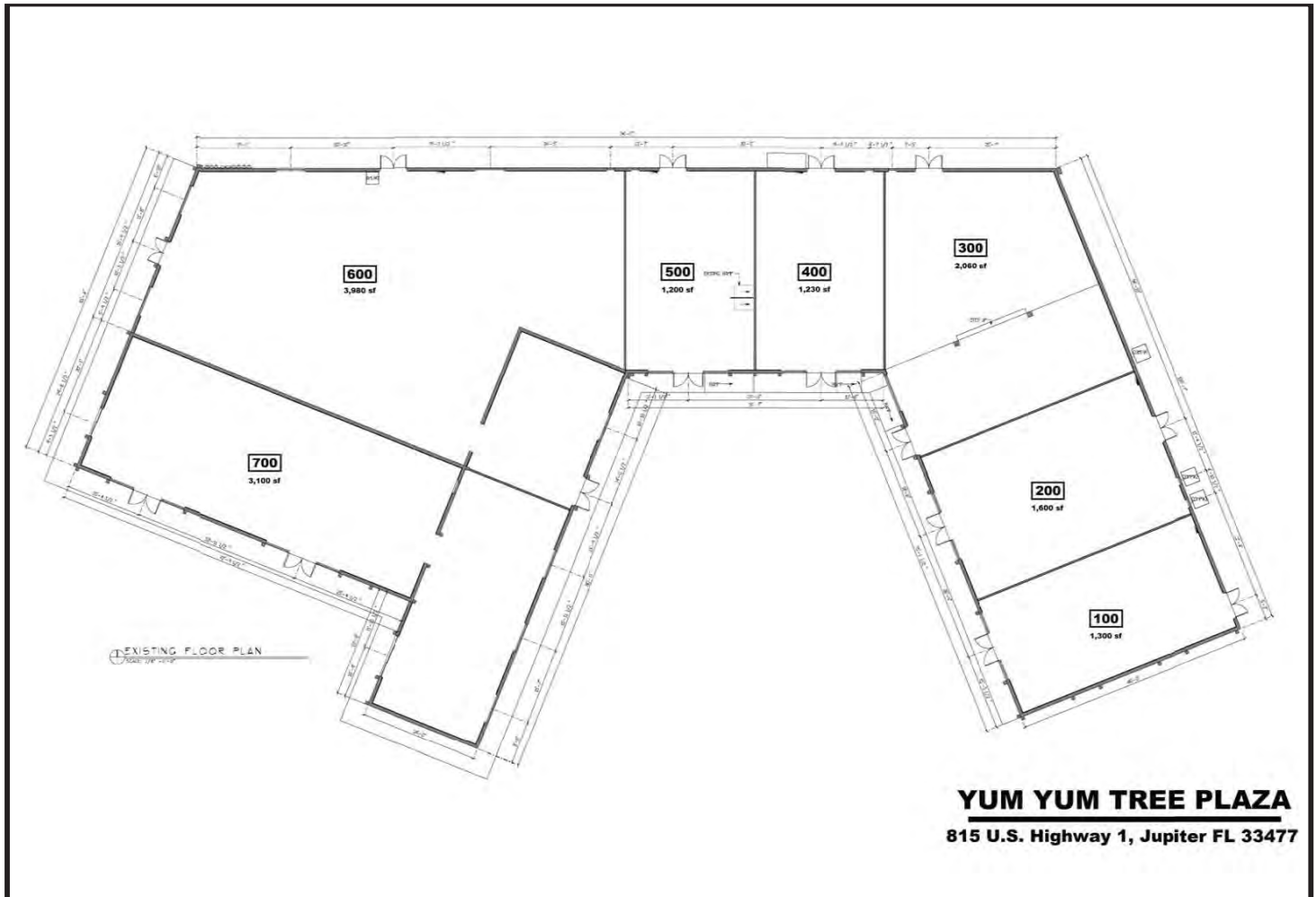

Cohen Commercial Realty, Inc.

Bryan S. Cohen | info@cohencommercial.com

Office: 561.471.0212 • Leasing: 561.471.1299 • Fax: 561.471.5905

533 NORTHLAKE BOULEVARD • NORTH PALM BEACH, FL 33408 • POST OFFICE BOX 14127 • NORTH PALM BEACH, FL 33408

LICENSED REAL ESTATE BROKER

All information regarding this property has been obtained from sources believed to be reliable. We make no guarantee, warranty, or representation about it. It independently confirm its accuracy and completeness. Any projections, assumptions, opinions or estimates used are for example only and do not represent current or future performance. You and your advisors should conduct a careful, independent investigation of the property to determine to your satisfaction the suitability of the property for your needs.