



20 WATERWAY ROAD

Tequesta, Florida 33469



PROPERTY FOR LEASE

- Brand new renovation - excellent opportunity for retail, office, and medical tenants
- Serves affluent, surrounding communities of Tequesta, Hobe Sound, Jupiter Island, and Jupiter
- Close proximity to Juno Beach
- Approximately +/- 1,000 up to 4,000 square feet available
- Approximately 23,742 cars pass on US-1 per day

DEMOGRAPHIC SUMMARY

	3-MILE RADIUS	5-MILE RADIUS
Postal count population	37,798	80,790
Median age	52.2	50.0
Estimated average Household Income	\$105,972	\$110,607
Estimated median Household Income	\$68,689	\$72,738

Cohen Commercial Realty, Inc.

Bryan S. Cohen | info@cohencommercial.com

Office: 561.471.0212 • Leasing: 561.471.1299 • Fax: 561.471.5905

533 NORTHLAKE BOULEVARD • NORTH PALM BEACH, FL 33408 POST OFFICE BOX 14127 • NORTH PALM BEACH, FL 33408

LICENSED REAL ESTATE BROKER

All information regarding this property has been obtained from sources believed to be reliable. We make no guarantee, warranty, or representation about it. It independently confirm its accuracy and completeness. Any projections, assumptions, opinions or estimates used are for example only and do not represent current or future performance. You and your advisors should conduct a careful, independent investigation of the property to determine to your satisfaction the suitability of the property for your needs.

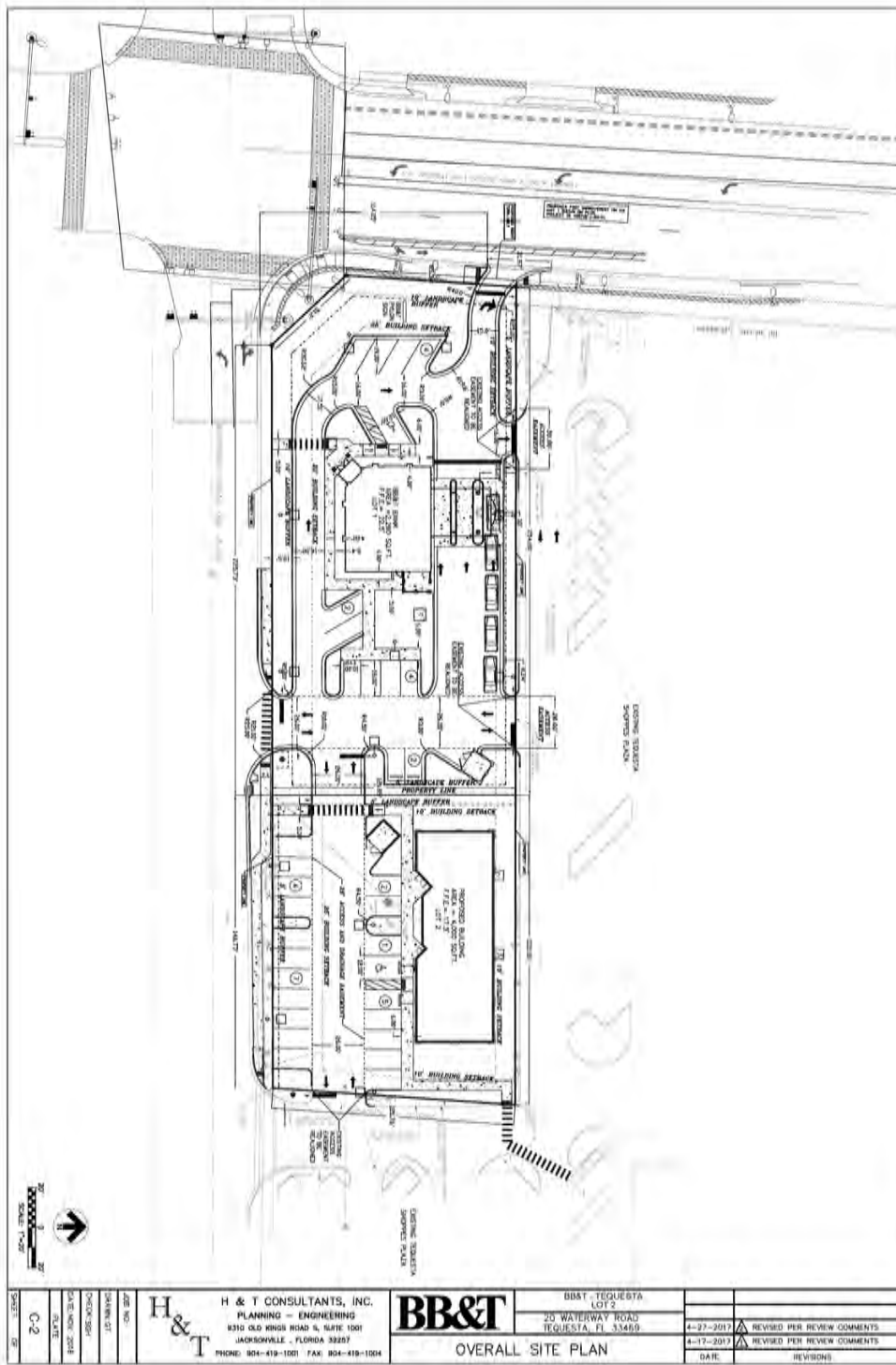

cohen
CC
commercial

Cohen Commercial Realty, Inc.

Bryan S. Cohen | info@cohencommercial.com

Office: 561.471.0201 • Leasing: 561.471.1299 • Fax: 561.471.5905

533 NORTHLAKE BOULEVARD • NORTH PALM BEACH, FL 33408 POST OFFICE BOX 14127 • NORTH PALM BEACH, FL 33408

LICENSED REAL ESTATE BROKER

All information regarding this property has been obtained from sources believed to be reliable. We make no guarantee, warranty, or representation about it. It independently confirm its accuracy and completeness. any projections, assumptions, opinions or estimates used are for example only and do not represent current or future performance. You and your advisors should conduct a careful, independent investigation of the property to determine to your satisfaction the suitability of the property for your needs.